

BANK & TRUST COMPANY

**Our Branches,
Their Locations,
and Geographies**

Our Branch Geographies

All of our branches are located in the state of Illinois

MAIN BANK 401 N Madison St Litchfield IL 62056	MSA: NA - Not Located in MSA County: 135 - Montgomery Census Tract: 9578.00 Tract Income Level: Middle
MONEY CENTRE 1201 W Union Ave Litchfield IL 62056	MSA: NA - Not Located in MSA County: 135 - Montgomery Census Tract: 9576.00 Tract Income Level: Upper
FARMERSVILLE 208 S Cleveland St Farmersville IL 62533	MSA: NA - Not Located in MSA County: 135 - Montgomery Census Tract: 9575.00 Tract Income Level: Middle
RAYMOND 404 S O'Bannon St Raymond IL 62560	MSA: NA - Not Located in MSA County: 135 - Montgomery Census Tract: 9575.00 Tract Income Level: Middle
CHATHAM 10 W Plummer Blvd Chatham IL 62629	MSA: 44100 - Springfield, IL County: 167 - Sangamon Census Tract: 0032.02 Tract Income Level: Upper
CARLINVILLE 900 W Main St Carlinville IL 62626	MSA: 41180 - St. Louis, MO-IL County: 117 - Macoupin Census Tract: 9564.00 Tract Income Level: Moderate
ROCHESTER 196 S Walnut St Rochester IL 62563	MSA: 44100 - Springfield, IL County: 167 - Sangamon Census Tract: 0039.01 Tract Income Level: Upper
WITT 1 W Broadway Witt IL 62094	MSA: NA - Not Located in MSA County: 135 - Montgomery Census Tract: 9574.00 Tract Income Level: Middle
COFFEEN 200 W Main St Coffeen IL 62017	MSA: NA - Not Located in MSA County: 135 - Montgomery Census Tract: 9580.00 Tract Income Level: Middle
FILLMORE 107 S Main St Fillmore IL 62032	MSA: NA - Not Located in MSA County: 135 - Montgomery Census Tract: 9580.00 Tract Income Level: Middle
IRVING 103 S Pine St Irving IL 62051	MSA: NA - Not Located in MSA County: 135 - Montgomery Census Tract: 9574.00 Tract Income Level: Middle

MAIN BANK

401 N Madison
Litchfield IL 62056

Date Opened: 1902
County: Montgomery

ATM on-site (accepts deposits)

Lobby

Monday – Friday 8:30 – 4:00
Saturday 8:30 – 12:00

Drive Thru Lanes

Monday – Thursday 8:00 – 5:00
Friday 8:00 – 6:00
Saturday 8:00 – 12:00

Phone: (217) 324-3935
Bookkeeping: (217) 324-6241
Fax: (217) 324-3535

Loan: (217) 324-7726
Trust: (217) 324-7728
Acct. Line 24: (800) 441-9579
Toll Free: (800) 930-3935



MONEY CENTRE

1201 W Union
Litchfield IL 62056

Date Opened: AUG 1988
County: Montgomery

ATM on-site (accepts deposits)

Lobby

Monday – Friday 8:30 – 4:00
Saturday 8:30 – 12:00

Drive Thru Lanes

Monday – Thursday 8:00 – 5:00
Friday 8:00 – 6:00
Saturday 8:00 – 12:00

Phone: (217) 324-3951

Fax (217) 324-5714



FARMERSVILLE

208 S Cleveland
Farmersville IL 62533

Date Opened: AUG 1985

County: Montgomery

ATM on-site (accepts deposits)

Lobby

Monday – Friday 8:30 – 4:00
Saturday 8:30 – 12:00

Drive Thru Lanes

Monday – Thursday 8:00 – 5:00
Friday 8:00 – 6:00
Saturday 8:00 – 12:00

Phone: (217) 227-3291
Fax: (217) 227-3685



RAYMOND

404 S O'Bannon
Raymond IL 62560

Date Opened: AUG 1995
County: Montgomery

ATM on-site (accepts deposits)

Lobby

Monday – Friday 8:30 – 4:00
Saturday 8:30 – 12:00

Drive Thru Lanes

Monday – Thursday 8:00 – 5:00
Friday 8:00 – 6:00
Saturday 8:00 – 12:00

Phone: (217) 229-3090

Fax: (217) 229-3336



CHATHAM

Date Opened: JAN 1996

10 Plummer Blvd
Chatham IL 62629

ATM on-site (accepts deposits)

Lobby

Monday – Friday 8:30 – 4:00
Saturday 8:00 – 12:00

Drive Thru Lanes

Monday – Thursday 8:00 – 5:30
Friday 8:00 – 6:00
Saturday 8:00 – 12:00

Phone: (217) 483-3343

Fax: (217) 483-3343

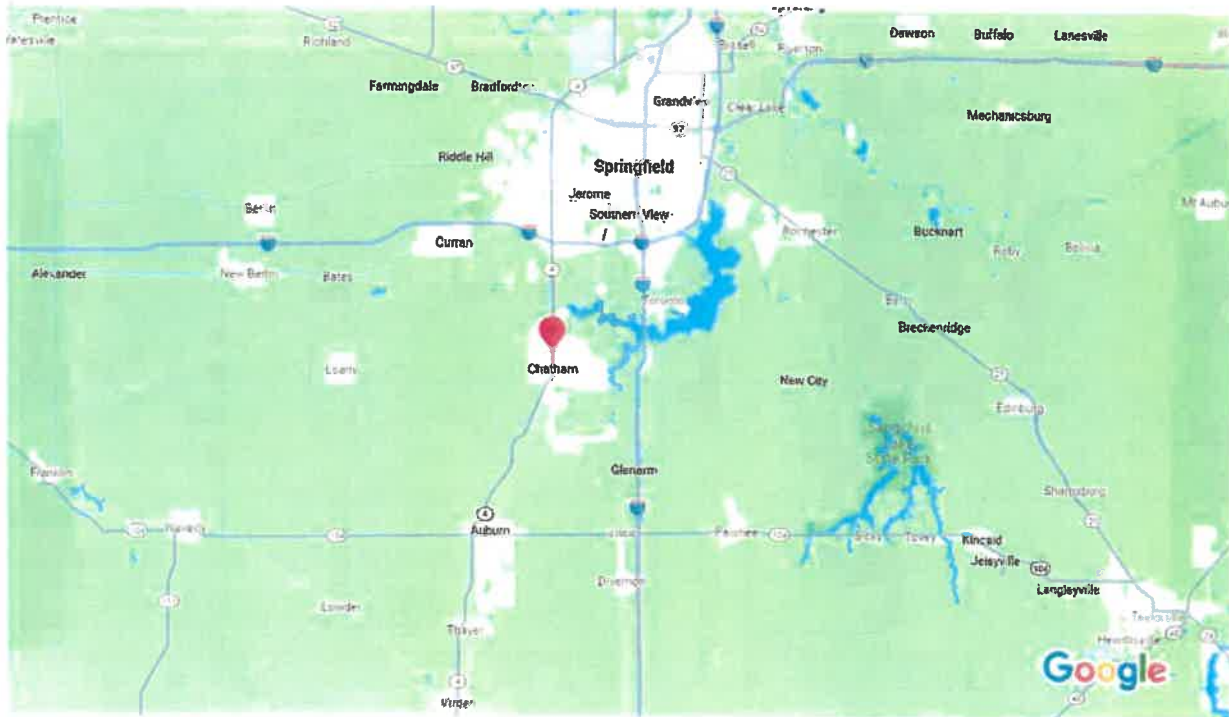

CARLINVILLE

900 W Main
Carlinville IL 62626

Date Opened: NOV 1997
County: Macoupin

ATM on-site (accepts deposits)

Lobby

Monday – Friday 8:30 – 4:00
Saturday 8:30 – 12:00

Drive Thru Lanes

Monday – Thursday 8:00 – 5:00
Friday 8:00 – 5:30
Saturday 8:00 – 12:00

Phone: (217) 854-3554
Fax: (217) 854-3244



ROCHESTER

Date Opened: MAR 1998

196 S Walnut St
Rochester IL 62563

ATM on-site (accepts deposits)

Lobby

Monday – Friday 8:30 – 4:00
Saturday 8:00 – 12:00

Drive Thru Lanes

Monday – Thursday 8:00 – 5:30
Friday 8:00 – 6:00
Saturday 8:00 – 12:00

Phone: (217) 498-9009

Fax: (217) 498-9901



WITT

1 W Broadway
Witt IL 62094

Date Opened: May 28, 2024

Lobby

Monday – Friday 8:30 – 4:00
Saturday 8:30 – 12:00

Drive Thru Lanes

Monday – Thursday 8:00 – 5:00
Friday 8:00 – 6:00
Saturday 8:00 – 12:00

Phone: (217) 594-2221

Fax: (217) 594-2255

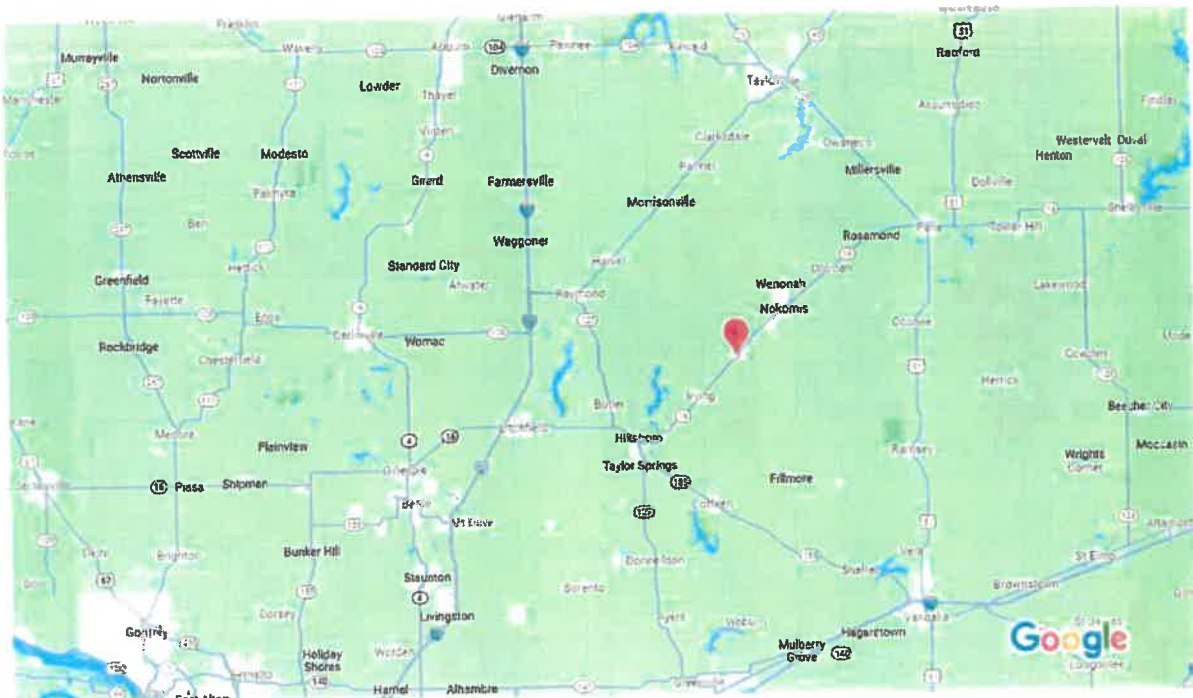

COFFEEN

Date Opened: May 28, 2024

200 W Main St
Coffeen IL 62017

Lobby

Monday – Friday 8:30 – 4:00
Saturday 8:30 – 12:00

Drive Thru Lanes

Monday – Thursday 8:00 – 5:00
Friday 8:00 – 5:30
Saturday 8:00 – 12:00

Phone: (217) 536-3950

Fax: (217) 536-3003

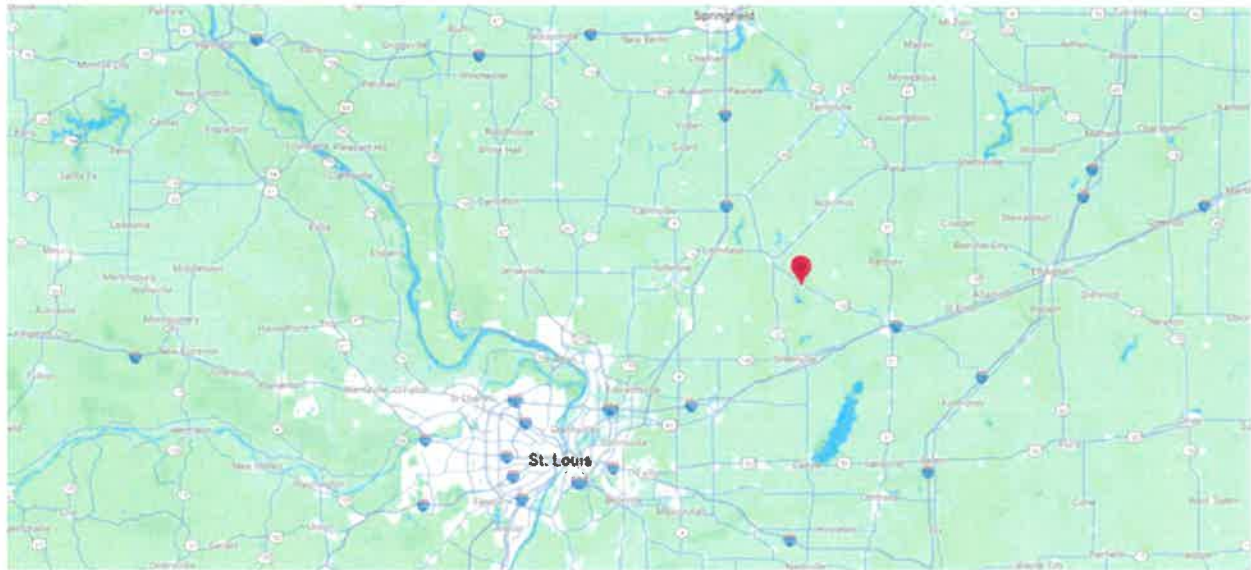

FILLMORE

Date Opened: May 28, 2024

107 S Main St
Fillmore IL 62032

Lobby

Monday – Wednesday 8:30 – 12:30,
2:00 – 5:00

Thursday & Saturday 8:30 – 12:00

Friday 8:30 – 12:30,
2:00 – 5:30

Phone: (217) 536-3940

Fax: (217) 536-3002

Drive Thru Lanes

Monday – Wednesday 8:30 – 12:30,
2:00 – 5:00

Thursday & Saturday 8:30 – 12:00

Friday 8:30 – 12:30,
2:00 – 5:30

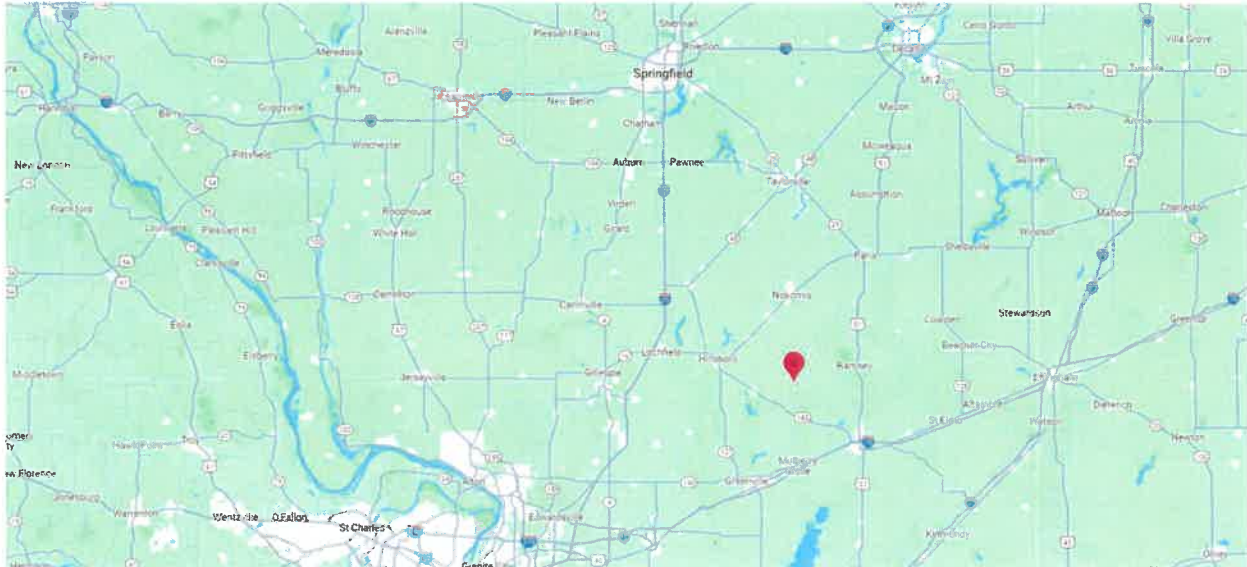

IRVING

Date Opened: May 28, 2024

103 S Pine St
Irving IL 62051

Lobby

Monday – Thursday 8:30 – 1:00,
2:00 – 5:00

Friday 8:30 – 1:00,
2:00 – 5:30

Saturday 8:30 – 12:00

Phone: (217) 536-3930

Fax: (217) 536-3001

Drive Thru Lanes

Monday – Thursday 8:30 – 1:00,
2:00 – 5:00

Friday 8:30 – 1:00,
2:00 – 5:30

Saturday 8:30 – 12:00

